

24G Nutriline Twin-Flo

Neonatal dual lumen catheter with Microflash introducer

24G Nutriline Twin-Flo has been designed specifically for use with babies who require multiple infusions. As with our other polyurethane catheters Nutriline Twin-Flo utilises thin-wall technology to enable optimum flow rates to be achieved.

The Nutriline Twin-Flo dual lumen design offers enhanced fluid management.

The kit for catheter insertion includes Vygon's Microflash introducer. This provides additional safety and security of advancing the catheter through plastic and the ability to completely remove the cannula after line insertion.

30cm, 24G Nutriline Twin-Flo is now also available with stylet to aid insertion with the improved Microflash introducer.

Features and Benefits

- **Polyurethane catheter** remains firm during insertion but softens at body temperature, minimising vessel trauma and enhancing stay time.
- **X-ray opaque** for accurate tip location without additional contrast medium.
- **New yellow Microflash introducer** unique split cannula, allows easy removal from the PICC line, and needle eyelet gives rapid visibility of flashback.

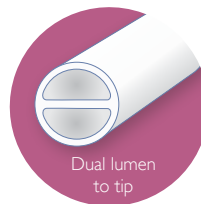

Kit Contents

- 1 x Nutriline Twin-Flo Catheter
- 1 x Tape measure
- 1 x New yellow Microflash introducer
- 1 x Neonatal Grip-Lok™

Ordering Information

Vygon Code	NHS Supply Chain Code	Description	Size (G)	Length (mm)	Priming Volume (ml)	Flow Rate (ml/min)*	Size (OD-L-G)	Unit of sale
1252.230	-	X-ray opaque graduated dual lumen PUR catheter with stylet	24	300	0.2 / 0.2	1.45 / 1.45	1.1-18-20	10
1252.235	FSU252	X-ray opaque graduated dual lumen PUR catheter	24	300	0.2 / 0.2	1.45 / 1.45	1.1-18-20	10
7370.19	FSP244	Microflash introducer	20	18	N/A	N/A	1.1-18-20	25
1147.02	FSU544	2Fr Microsite introducer	20	18	N/A	N/A		10

2Fr Microsite

2Fr Microsite provides increased puncture accuracy and greater placement success in neonates. It further reduces trauma and stress in newborns receiving central access and allows insertion of 1Fr & 2Fr longlines with a 24G needle or cannula. 2Fr Microsite is sold separately.

Insertion technique

for 24G Nutriline Twin-Flo

Preparation for Catheter Insertion

Open using aseptic technique. Add any sterile supplementary equipment needed. Ensure you are using maximum barrier precautions, such as the longline placement pack: 80.199.519. Put on sterile gloves, prepare tray contents ready for catheter insertion:

1. Draw-up saline and heparin flushes using a filter needle or straw to remove particulate material.
2. Flush catheter prior to insertion.

Microflash Peelable Cannula Insertion Technique

1. Select, prepare, clean (see diagram 1) and drape site of venepuncture. Apply tourniquet.
2. Perform venepuncture with the peelable cannula provided (see diagram 2).
3. Advance cannula until venepuncture is confirmed by free flowing blood into the flashback chamber (see diagram 3). **Please note:** *With Microflash you may see flashback from the needle eyelet.* The cannula can also be syringe-mounted if preferred.
4. Release tourniquet, advance cannula off the introducer needle and advance gently into vessel. **Please note:** *To avoid excessive bleeding or possible air aspiration place a gloved finger over the cannula opening following needle withdrawal.* Insert catheter through cannula using non-toothed forceps and short, steady strokes (see diagram 4).

Should catheter advancement become difficult, infuse a little fluid whilst simultaneously advancing the catheter. This has the effect of dilating the vessel distal to the catheter tip.

Nutriline Twin-Flo Peelable Cannula Removal

1. Secure the catheter by applying light finger pressure on the catheter beyond the cannula and slowly withdraw the cannula. Carefully peel the cannula apart whilst maintaining forward pressure on the catheter, taking care not to dislodge the catheter from the vein. Finally advance the catheter to the desired position (see diagram 5).

Nutriline Twin-Flo Catheter Fixation

1. Anchor the catheter using adhesive neonatal Grip-Lok™. Clean the insertion site with gauze swab. Place small swab over insertion site if necessary (see diagram 6).
2. Loop the extension tube back beside this gauze and apply a transparent dressing (see diagram 7). Light pressure over the insertion site should be maintained for 24 hours. Change as per hospital protocol.

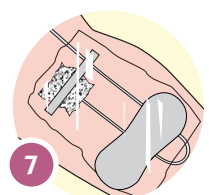
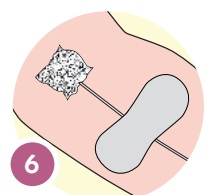
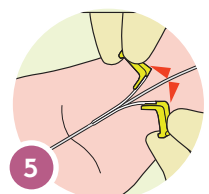
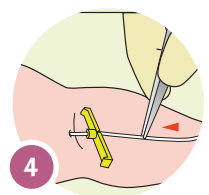
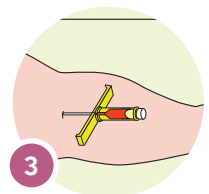
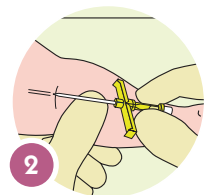
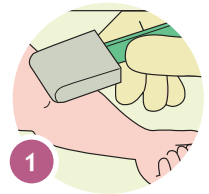

Warnings: Avoid the use of alcohol or acetone to clean the catheter as this may result in catheter damage and premature removal. Avoid the use of small syringes less than 10ml for bolus injections as they generate high pressures which may result in catheter damage.